

Background Document C-1

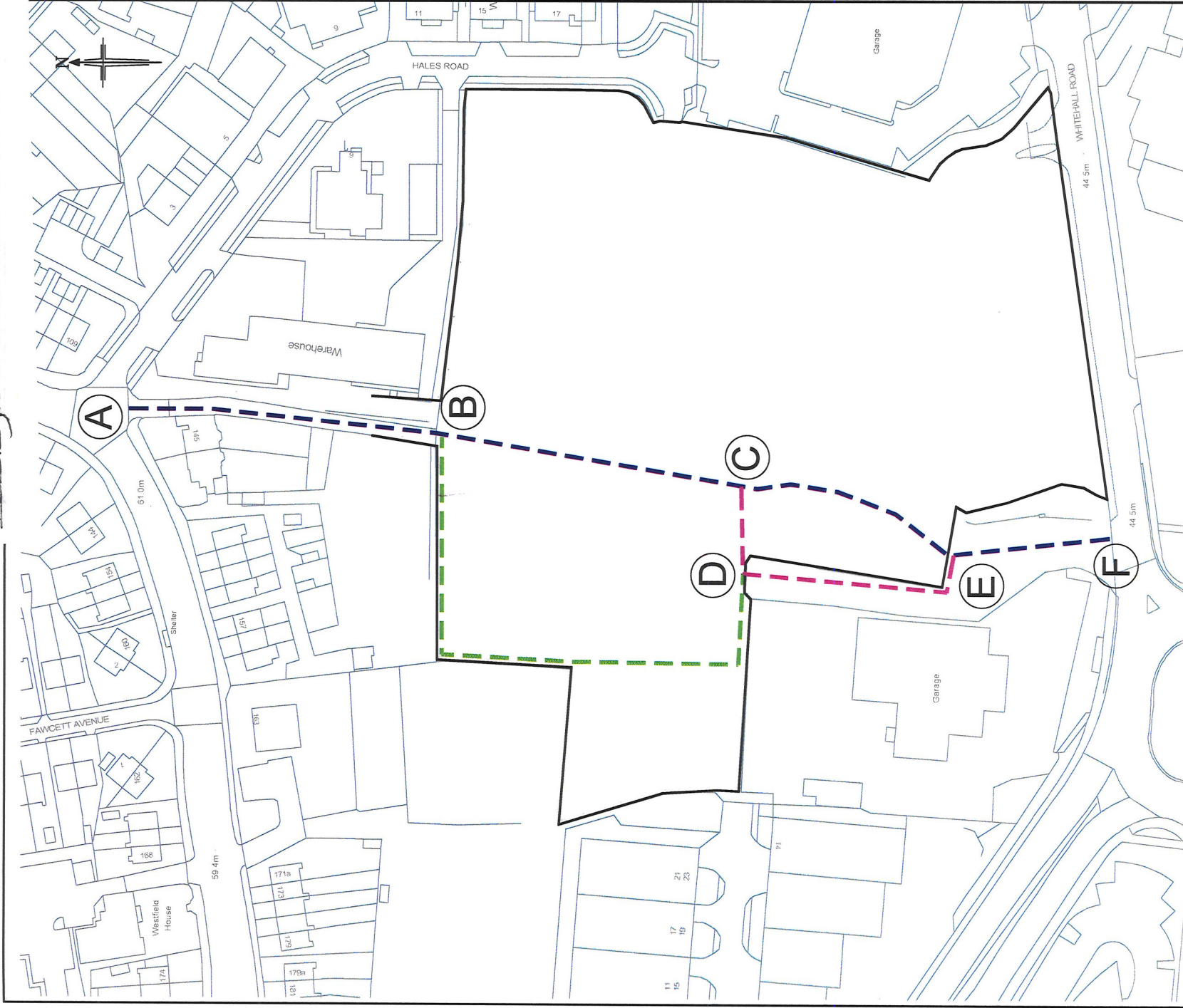

<p>Key</p> <ul style="list-style-type: none"> --- Existing route of non-definitive footway as per LCC PROW Map --- Existing route of non-definitive footway as it currently operates. --- Proposed route realignment 	<p>A</p> <p>Amended PROW routes, added OS mapping as background.</p>		NC	AC	19.12.17
	<p>Rev: Amendment:</p> <p>Status:</p>	DRN:	CHK:	Date:	
<p>Client: J PULLAN & SONS</p> <p>Project: WORTLEY LOW MILLS</p>		<p>Drawing No: 17/286/LOC/004</p> <p>Job No: 17-286</p>		<p>Date: 12.12.2017</p> <p>Revision: A</p> <p>Scale: 1:1,000</p> <p>Checked: AC</p>	
<p>BRYAN G HALL CONSULTING CIVIL & TRANSPORTATION PLANNING ENGINEERS Copyright Reserved Bryan G Hall Ltd. www.bryanghall.co.uk</p>		<p>Lighterman House 26/28 Whitehall Road COLTON LEEDS LS1 9RT T 0113 234 2201</p>		<p>Title: S257 STOPPING UP & DIVERSION ORDER LOCATION PLAN</p>	